

Ⓓ Aufbauanleitung

Ⓕ Notice de montage

Ⓖ Montagehandleiding

Ⓒ Montážní návod

Ⓗ Szerelési útmutató

Ⓓ Montaj talimatları

Ⓖ Assembly instruction

Ⓙ Istruzione di montaggio

Ⓟ Instrukcja montażu

Ⓙ Navod na montaž

Ⓡ Instrucțiuni de montaj

Ⓡ Инструкция по монтажу

# 36-4529-82-000

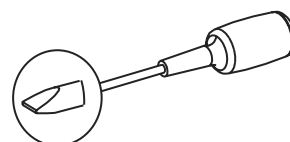
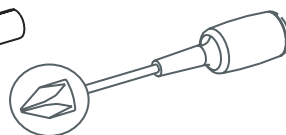
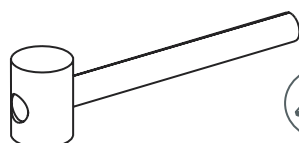
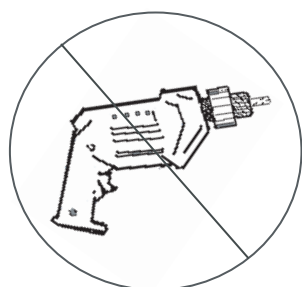
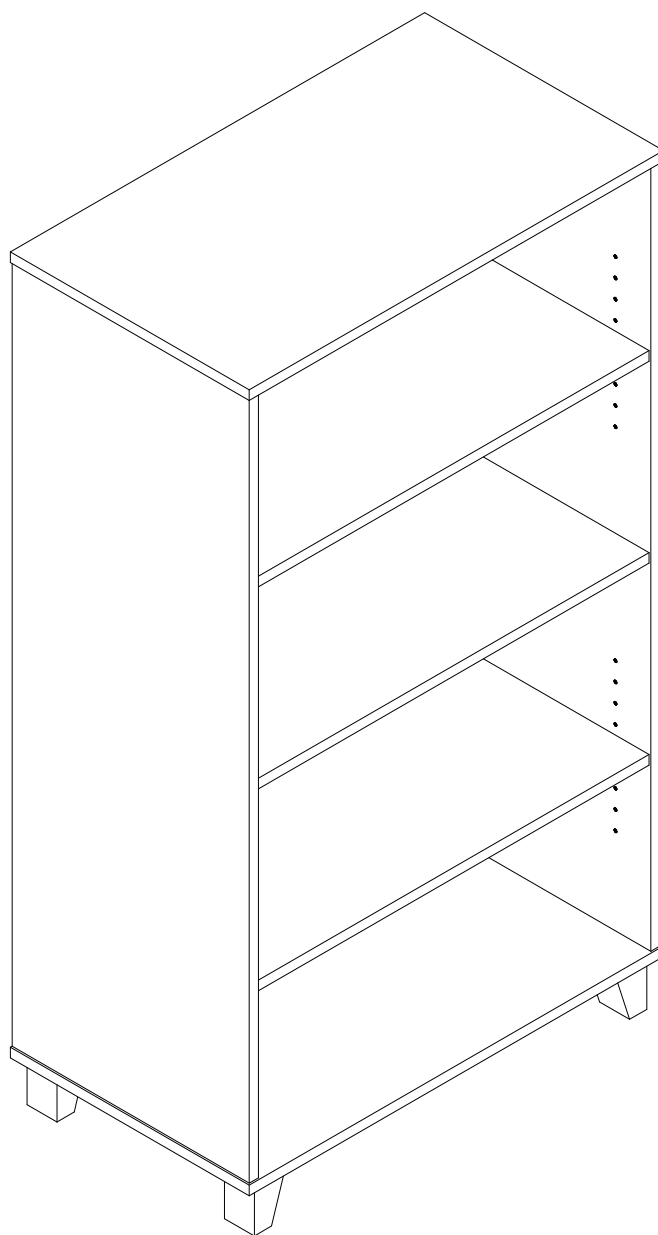

# Service • Assistenza • Dienstverlening • Serwis Servis • Szerviz • Сервисная служба

Name • Nom • Nome • Naam • Nazwa • Jméno • Názov  
Név • Denumire • Isim • Название

Nr. Nr. • No. • N° • Č • Sz • Номер

Typ • Тип • Type • Tip • Tipus • Druh • Тиро • Тип

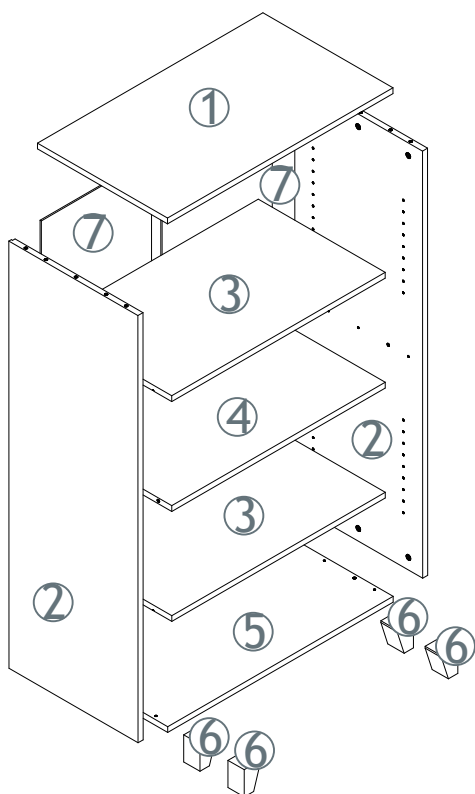
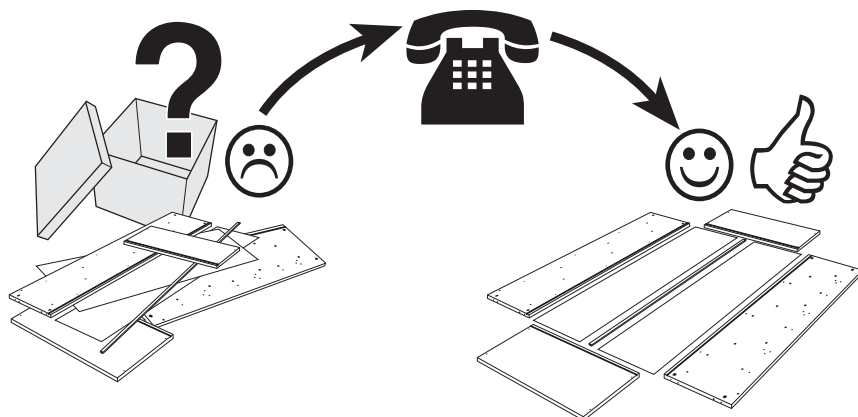
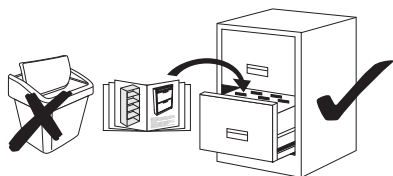

## Detail specification

A.i. Nr.	Article Nr.	pcs
①	208434-82	x1
②	208438-82	x2
③	208435-82	x2
④	208436-82	x1
⑤	208437-82	x1
⑥	208439-32	x4
⑦	208441-52	x2

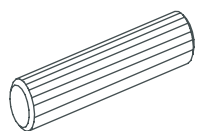
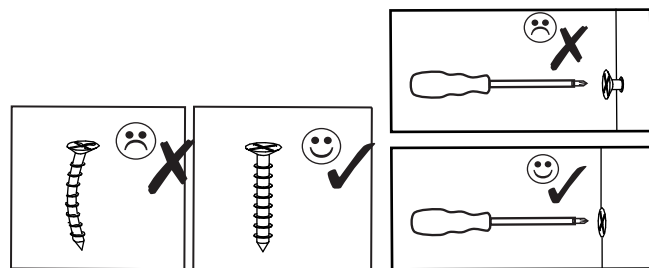

a

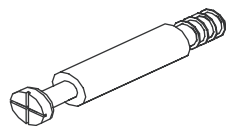

b

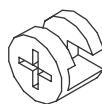

c

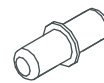

d



e



f



g

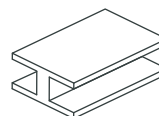

h

## Fitting specification

A.i. Nr.	Article Nr.	Dimensions	pcs
a	1-000013-00	8x40	x20
b	1-000121-07	34+11	x18
c	1-000048-07	15x12	x18
d	1-000053-07	D5/5	x8
e	1-000112-57	4x17	x18
f	1-000015-07	15gr.	x1
g	1-000062-07	3x20	x18
h	1-000082-57	1179mm	x1

Make sure that there are no loose and leave screws!  
Stellen Sie sicher, dass keine losen Schrauben und verlassen!  
Zorg ervoor dat er geen losse en laat schroeven!  
Assurez-vous qu'il n'y a pas lâches et laissent vis!

1-000001=

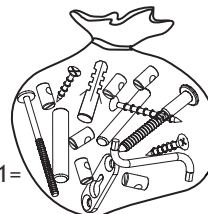

1.

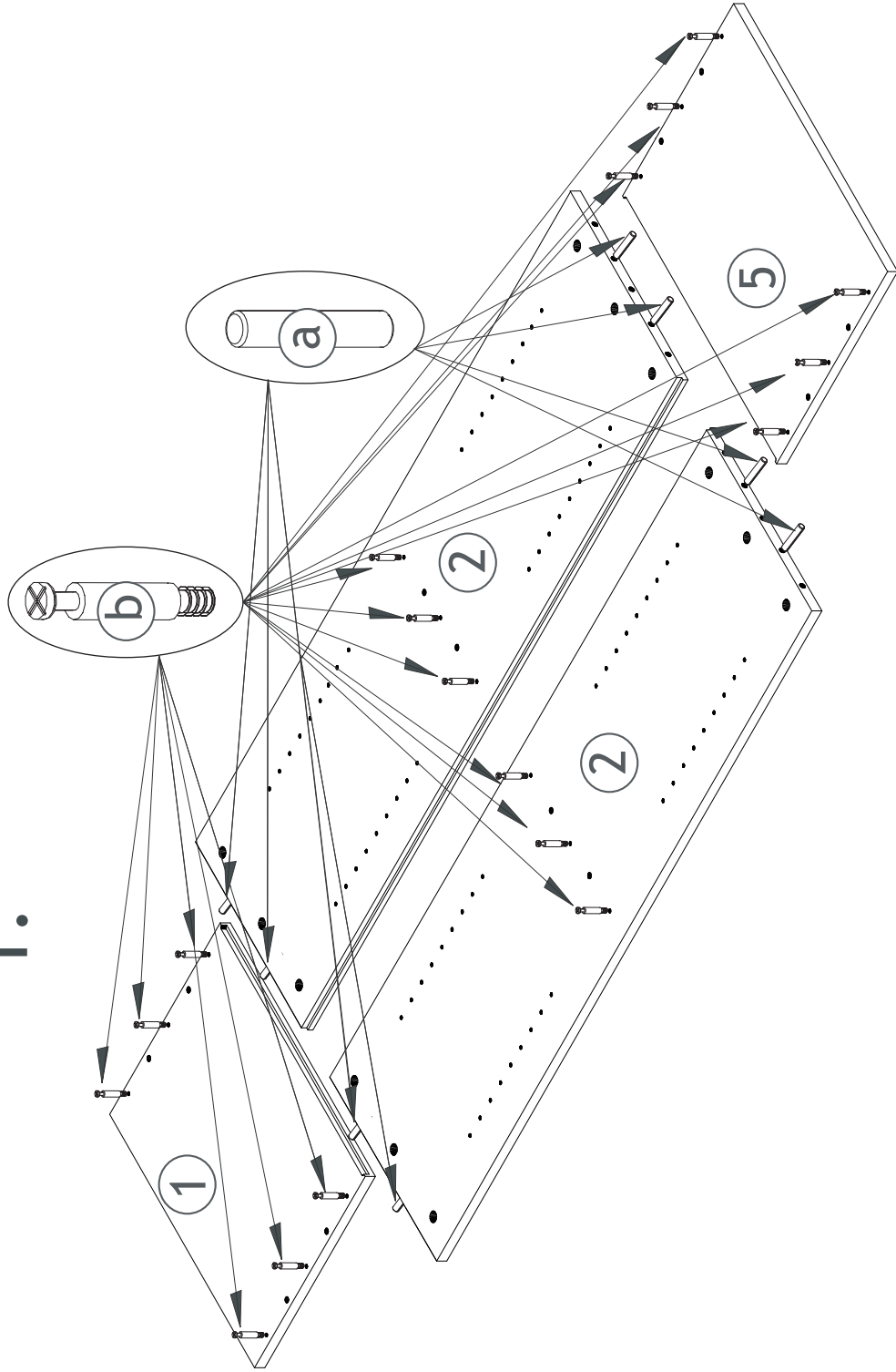

2.1.

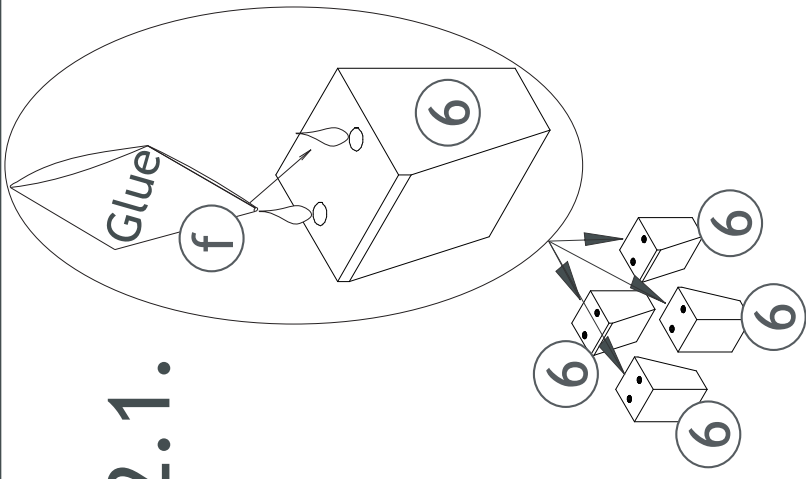

2.2.

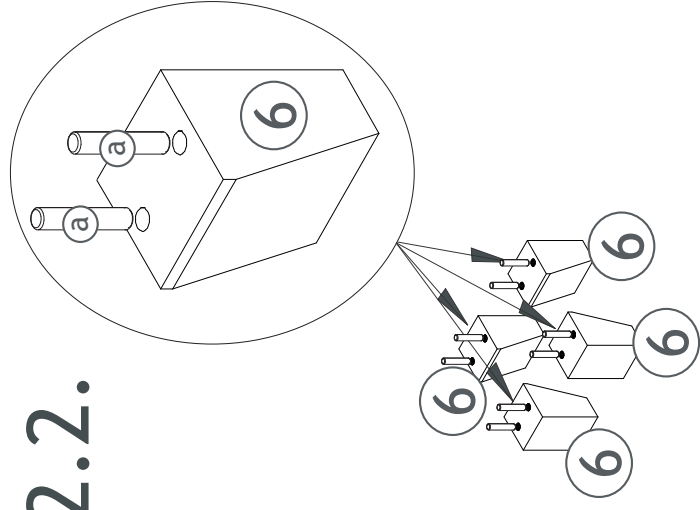

3.

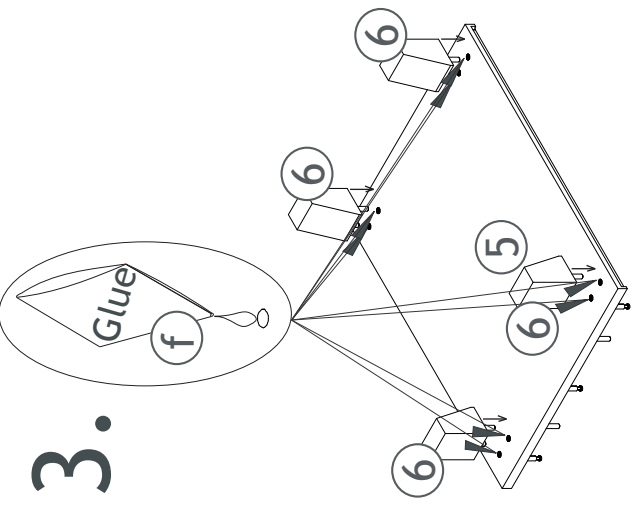

4.

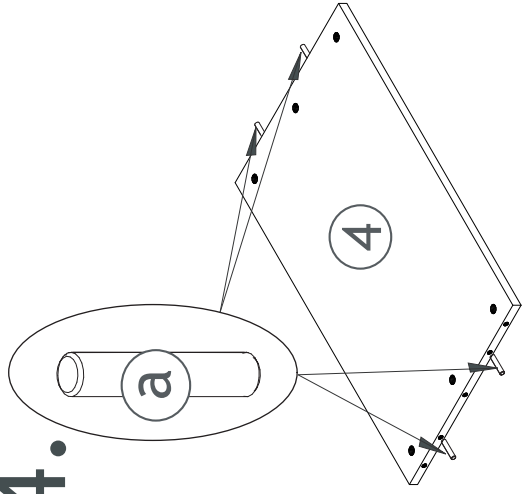

5.

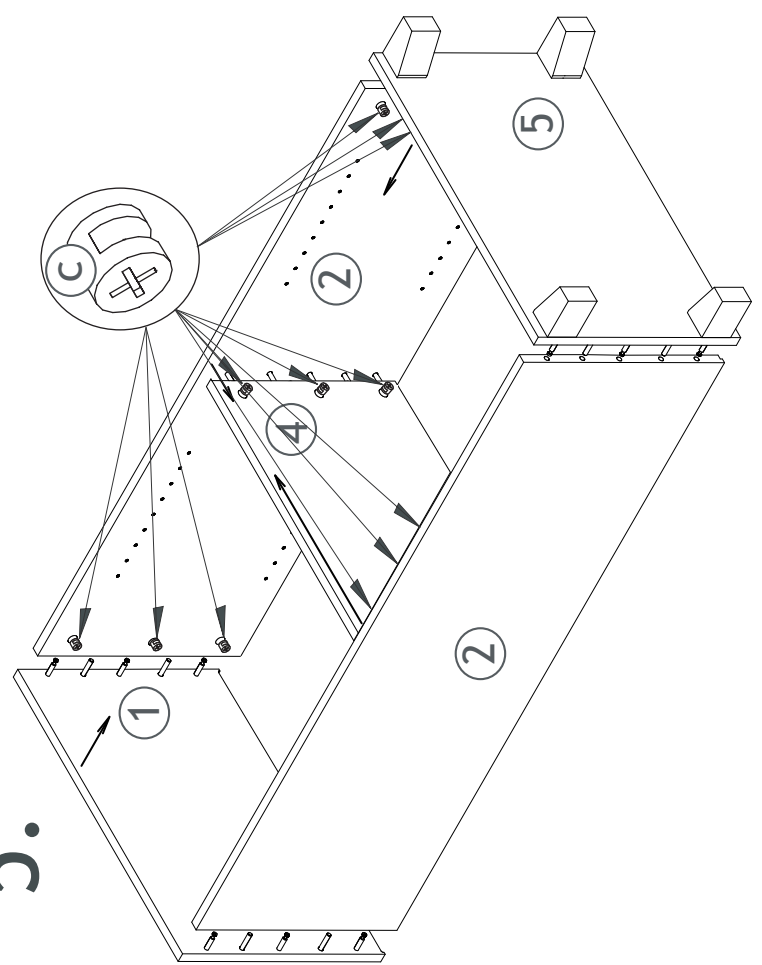

6.

